

# Montageanleitung

Ⓒ mounting instruction Ⓕ Notice de montage Ⓒ Instrukcja montażu  
Ⓔ Instrucciones de montaje Ⓘ Istruzioni di montaggio

## Maxi-Flat-Pen 40/50/60 E14

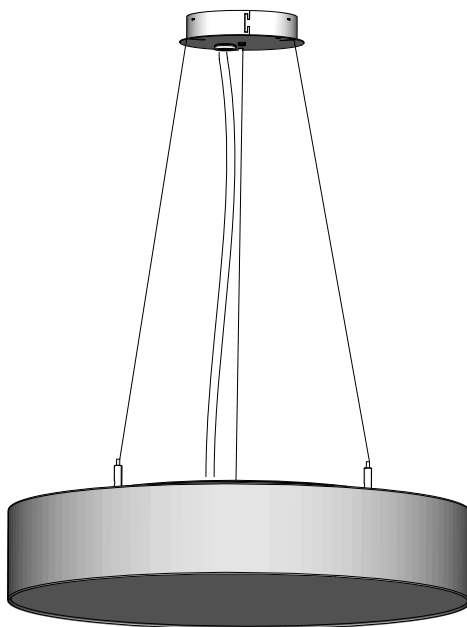

RIDI Leuchten GmbH  
• Hauptstrasse 31 - 33 • D-72417Jungingen  
• Tel. 07477/872-0 • Fax 07477/872-48  
• kontakt@ridi-group.de • www.ridi-group.com



- D** Für die Installation und für den Betrieb der Leuchten sind die nationalen Sicherheitsvorschriften zu beachten.
- GB** Please note national safety instructions for installation and operation of this luminaire.
- F** Pour l'installation et le fonctionnement des luminaires il est impératif de respecter les normes nationales de sécurité en vigueur.
- PL** W celu prawidłowej instalacji i poprawnego działania oprawy należy przestrzegać krajowych przepisów bezpieczeństwa.
- E** Para la instalación y la puesta en funcionamiento de las luminarias deben observarse las normas nacionales de seguridad.
- I** Per l'installazione e il funzionamento delle lampade si fa riferimento alle normative di sicurezza nazionali.

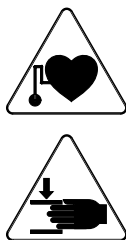

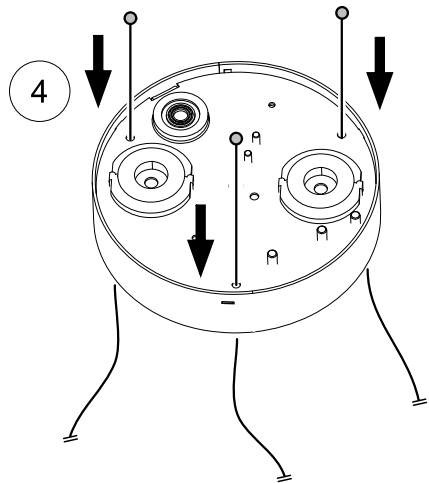
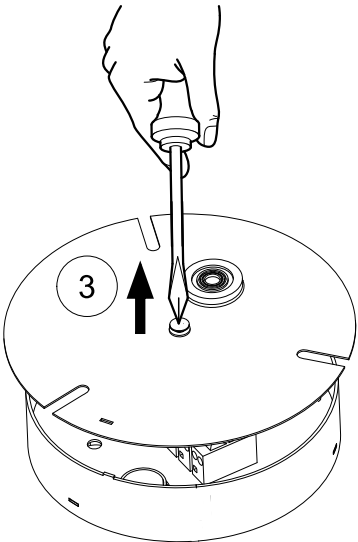
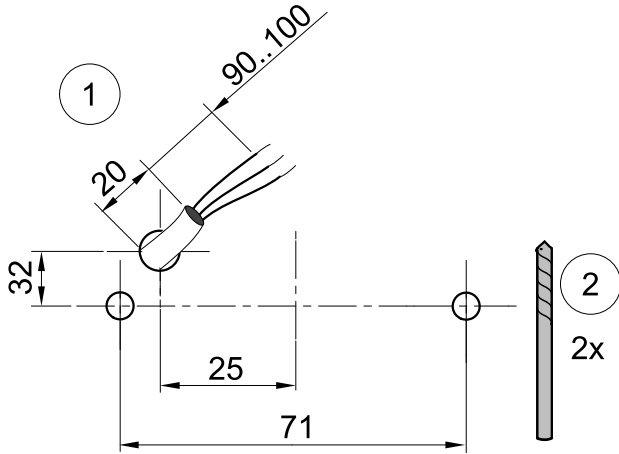

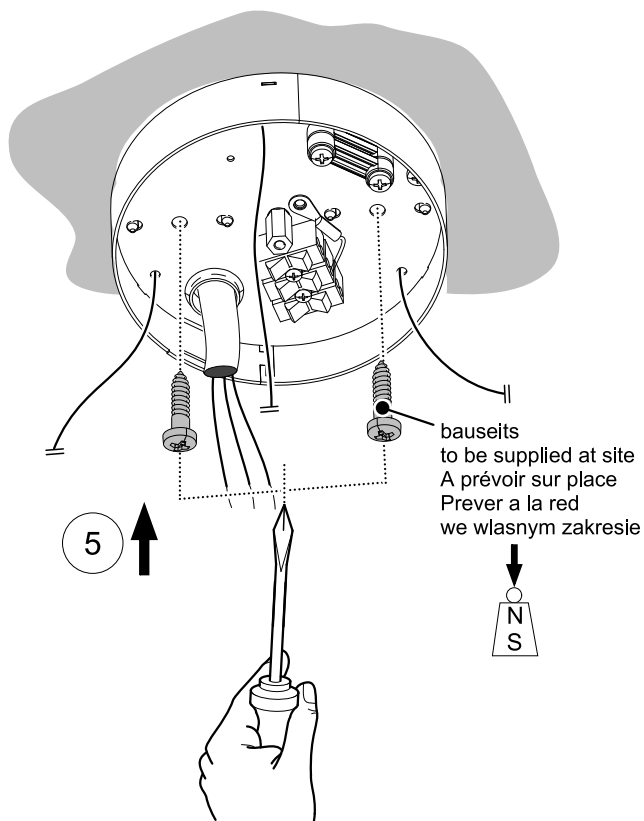

Typ	
Maxi-Flat 40/50-PEN...E14	100N
Maxi-Flat 60-PEN...E14	134N

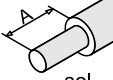

	mm <sup>2</sup>	A
sol.	0,5-1,0	8
	1,5-2,5	9

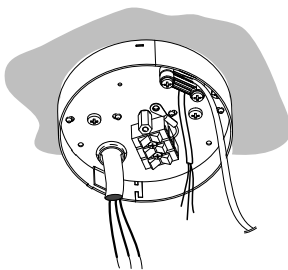
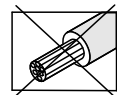

**RIDI** .....  
 .....  
 .....  
 AC 230-240V/50-60Hz

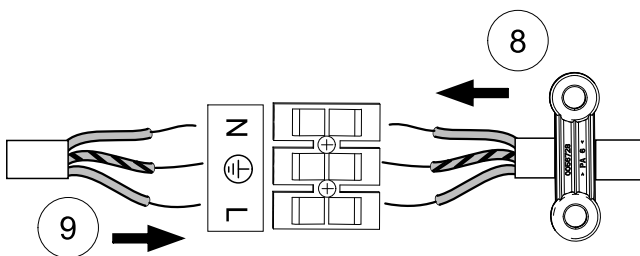
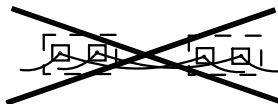

8a

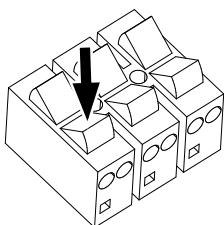

8b

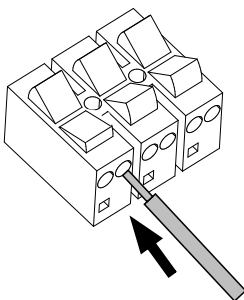

8c

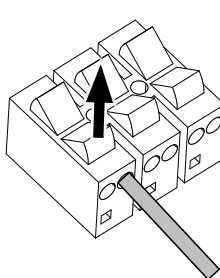

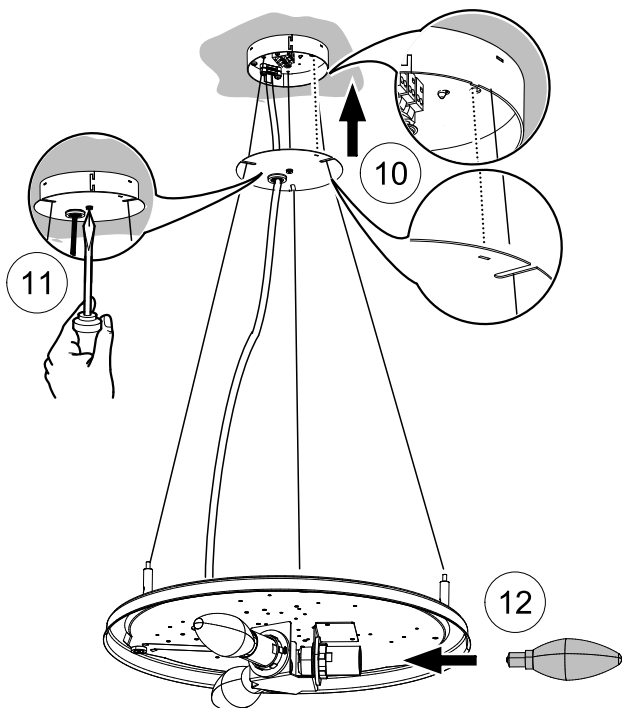

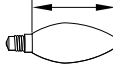
Typ		max. 
Maxi-Flat 40/50-PEN...E14	3xE14 25W	80
Maxi-Flat 60-PEN...E14	4xE14 25W	

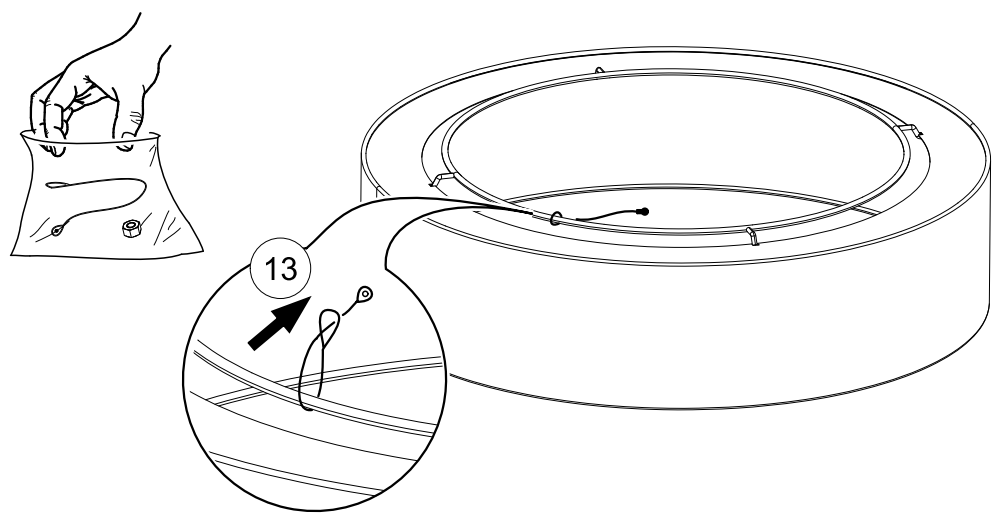

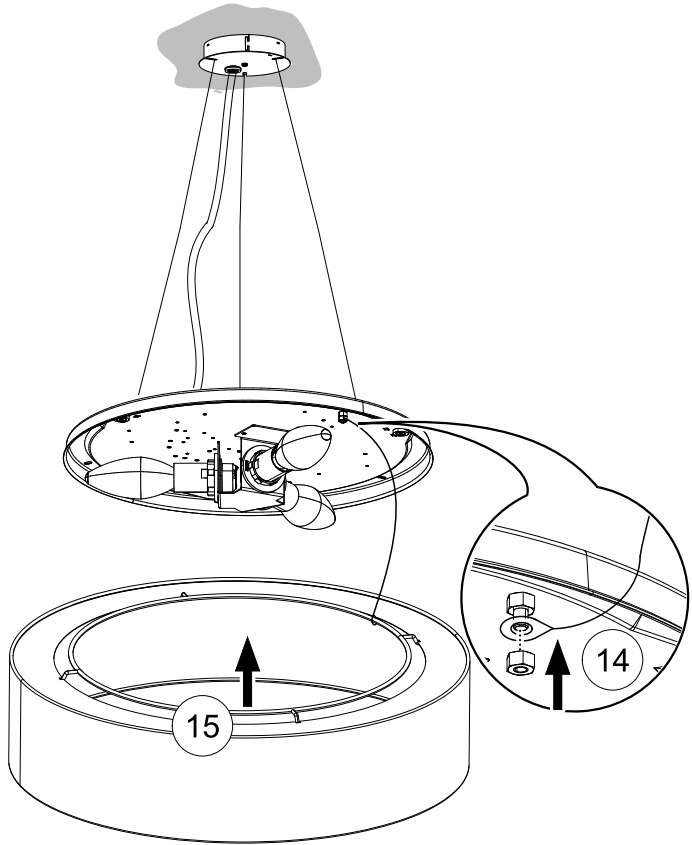
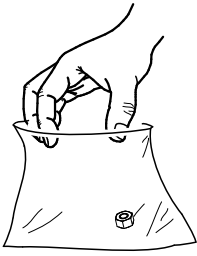

Typ	
Maxi-Flat 40/50-PEN...E14	Maxi-Flat-Korona 40x10... Maxi-Flat-Korona 50x10...
Maxi-Flat 60-PEN...E14	Maxi-Flat-Korona 60x10...