

### Pultoberteile

Breite 600/800 mm  
TP 6720.500, TP 6721.500

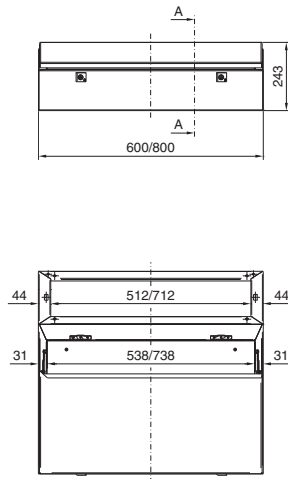

Breite 1200/1600 mm  
TP 6722.500, TP 6723.500

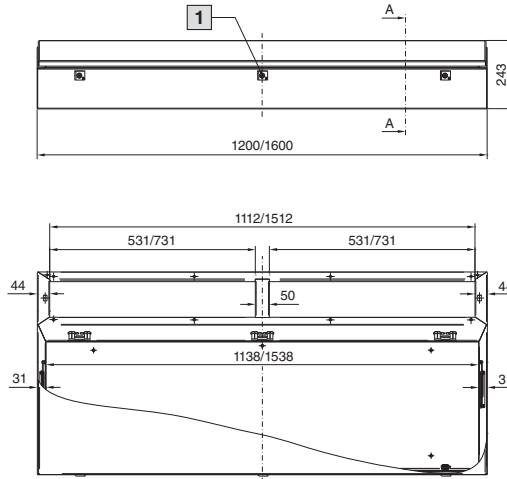

Schnitt A - A

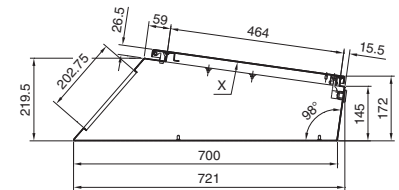

1 Nur bei Breite 1600 mm

**Hinweis:**  
- Ansicht X, siehe Seite 2

### Pultmitteile, vorbereitet für Pultoberteil

Breite 600/800 mm  
TP 6714.500, TP 6715.500

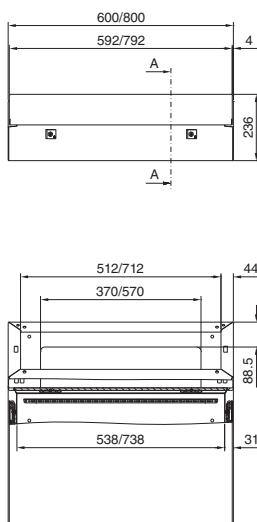

Breite 1200/1600 mm  
TP 6716.500, TP 6717.500

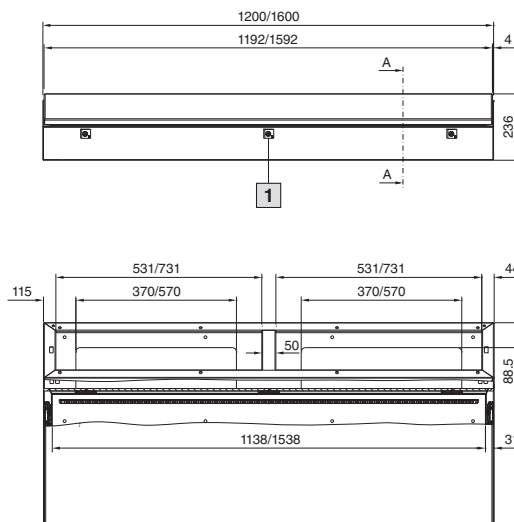

Schnitt A - A

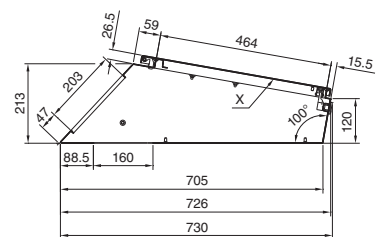

1 Nur bei Breite 1600 mm

**Hinweis:**  
- Ansicht X, siehe Seite 2

# Schaltschränke

## TopPult-System TP

### Pultmitteile, hinten mit Deckel scharniert

Breite 600/800 mm  
TP 6710.500, TP 6711.500

Breite 1200/1600 mm  
TP 6712.500, TP 6713.500

Schnitt A – A

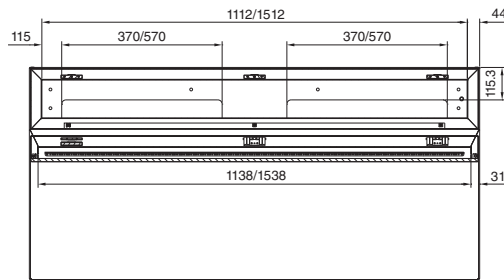
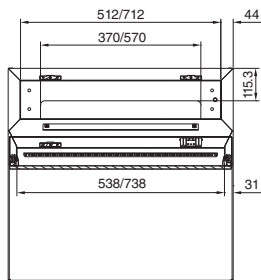
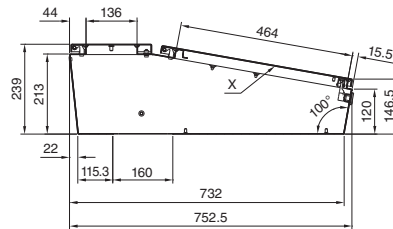
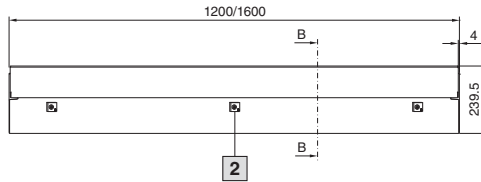
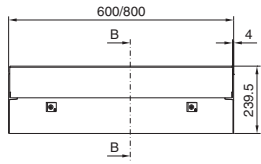

Ansicht X

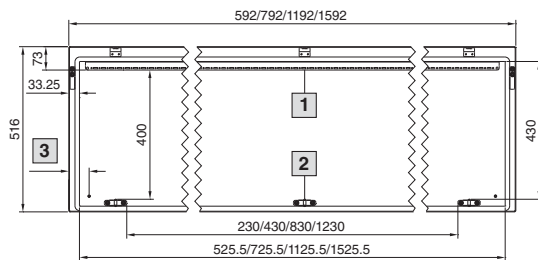

- 1 Entfällt bei Breite 600/800 mm
- 2 Nur bei Breite 1600 mm
- 3 Breite = 600/800/1200 = 63,5 mm  
Breite = 1600/163,5 mm

### Pultunterteile, Tiefe 400 mm

Breite 600/800 mm  
TP 6700.500, TP 6701.500

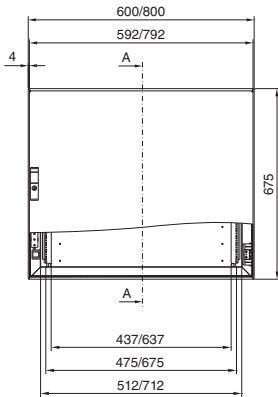

Breite 1200/1600 mm  
TP 6702.500, TP 6703.500

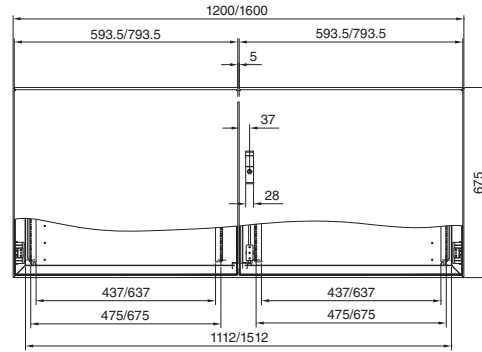

Schnitt A - A

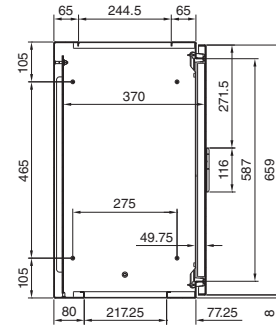

Montageausschnitt

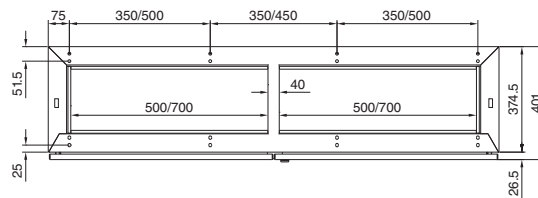
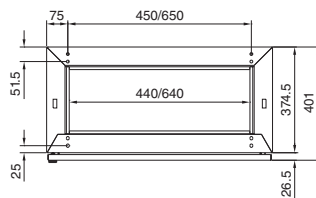
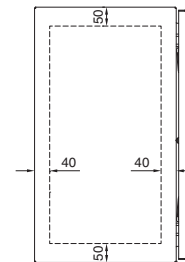

Montageplatte

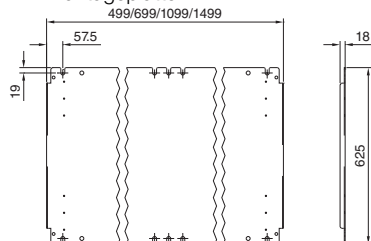

# Schaltschränke

## TopPult-System TP

### Pultunterteile, Tiefe 500 mm

Breite 600/800 mm  
TP 6704.500, TP 6705.500

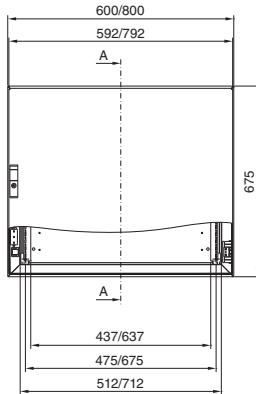

Breite 1200/1600 mm  
TP 6706.500, TP 6707.500

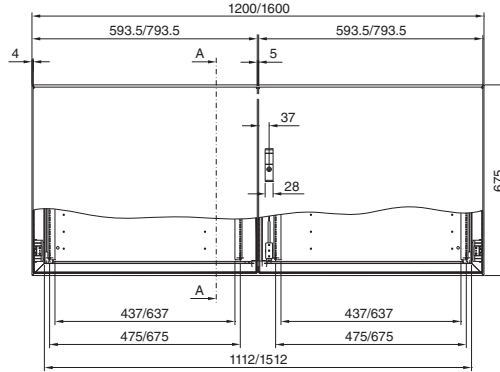

Schnitt A – A

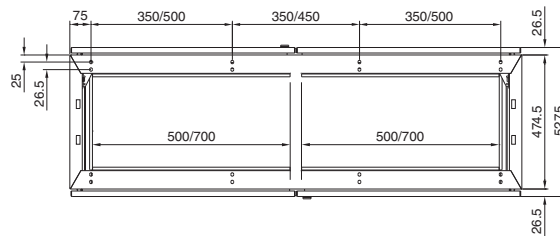
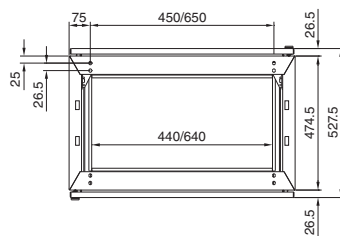
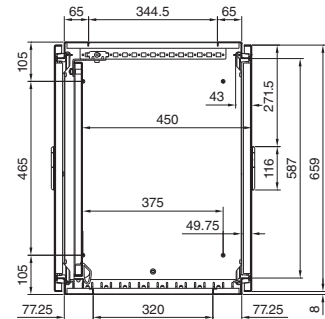

Montageausschnitt

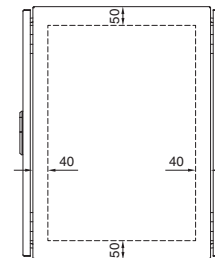

Montageplatte

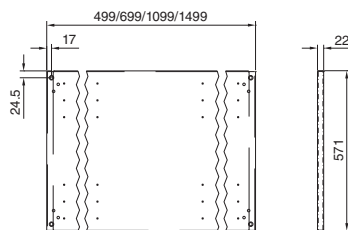

### Kombinationsmöglichkeiten

Aufbau 3-teilig

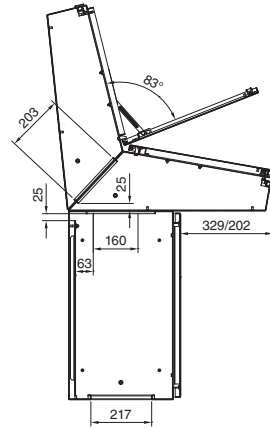
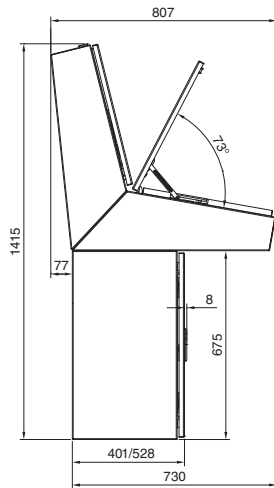

Aufbau 2-teilig

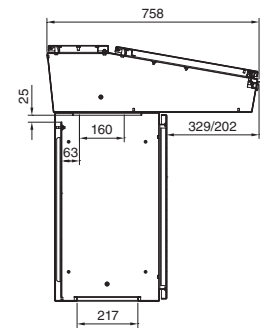
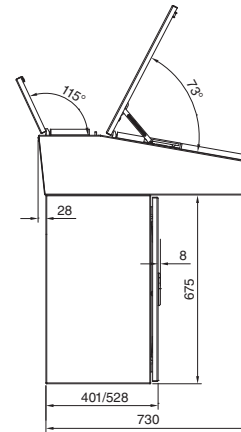

Aufbau 1-teilig

